

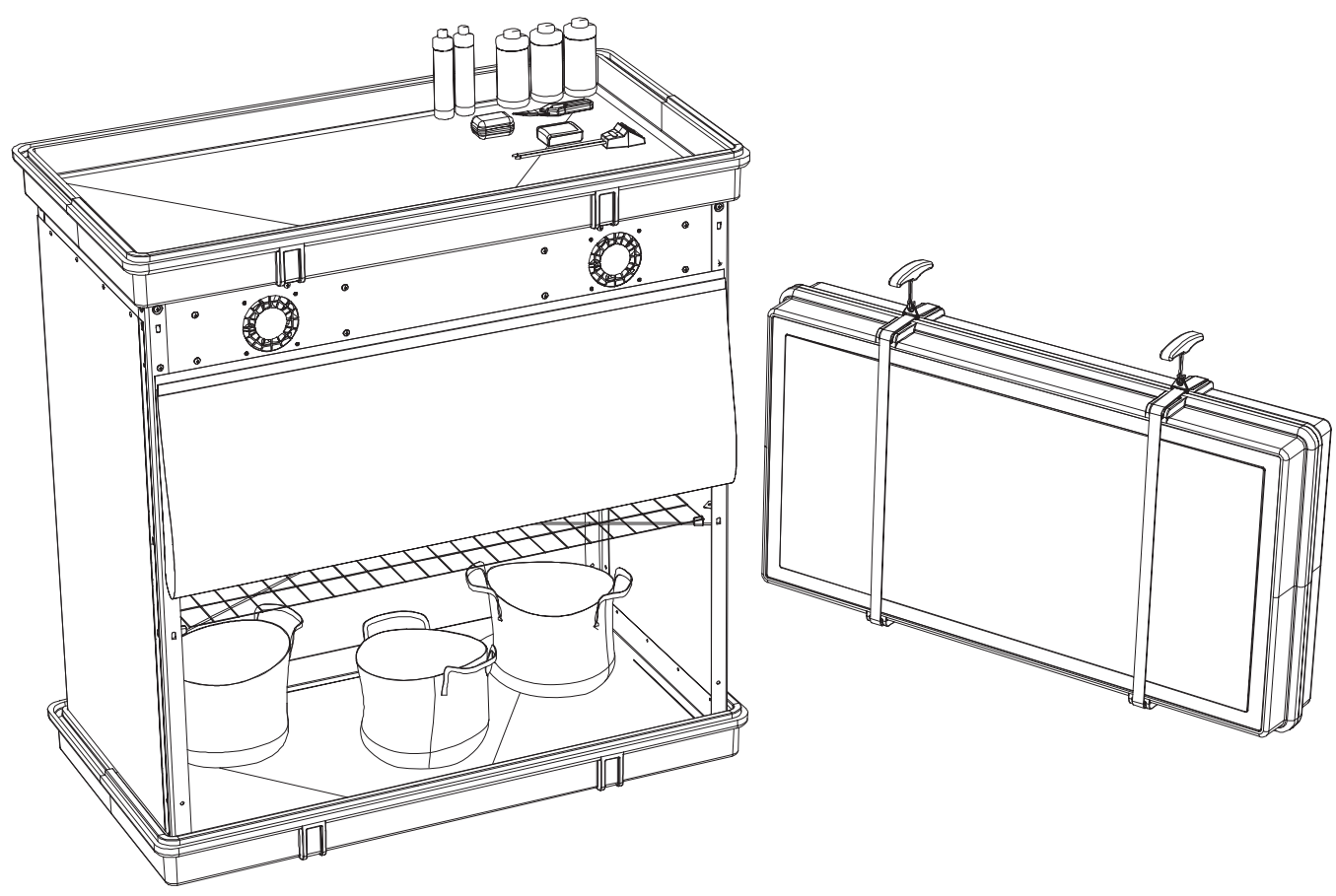

ASSEMBLY INSTRUCTIONS



IMPORTANT
Read all instructions before proceeding with assembly. Important details pertaining to proper set-up are Highlighted.

RETAIN THIS MANUAL FOR FUTURE PART NUMBER REFERENCE



WATCH! For a step-by-step visual guide to assembling your GROWCASE, we recommend watching our comprehensive assembly video on YouTube.



The estimated assembly time for 1-2 people is 30-40 minutes.

CHECK to ensure you received all the required parts and without damage. If you have an issue, visit the GROWCASE website to file a claim.

TOOLS REQUIRED

Phillips Head
Screwdriver
#1 and #2
(To fasten screws)



Adjustable Wrench
(To tighten nuts)



Rubber Mallet
(To set frame members)



Scissors
(To cut Velcro)



Pliers
(To crimp grommets)



Tape Measure
(to measure Velcro)



PACKAGED COMPONENTS:

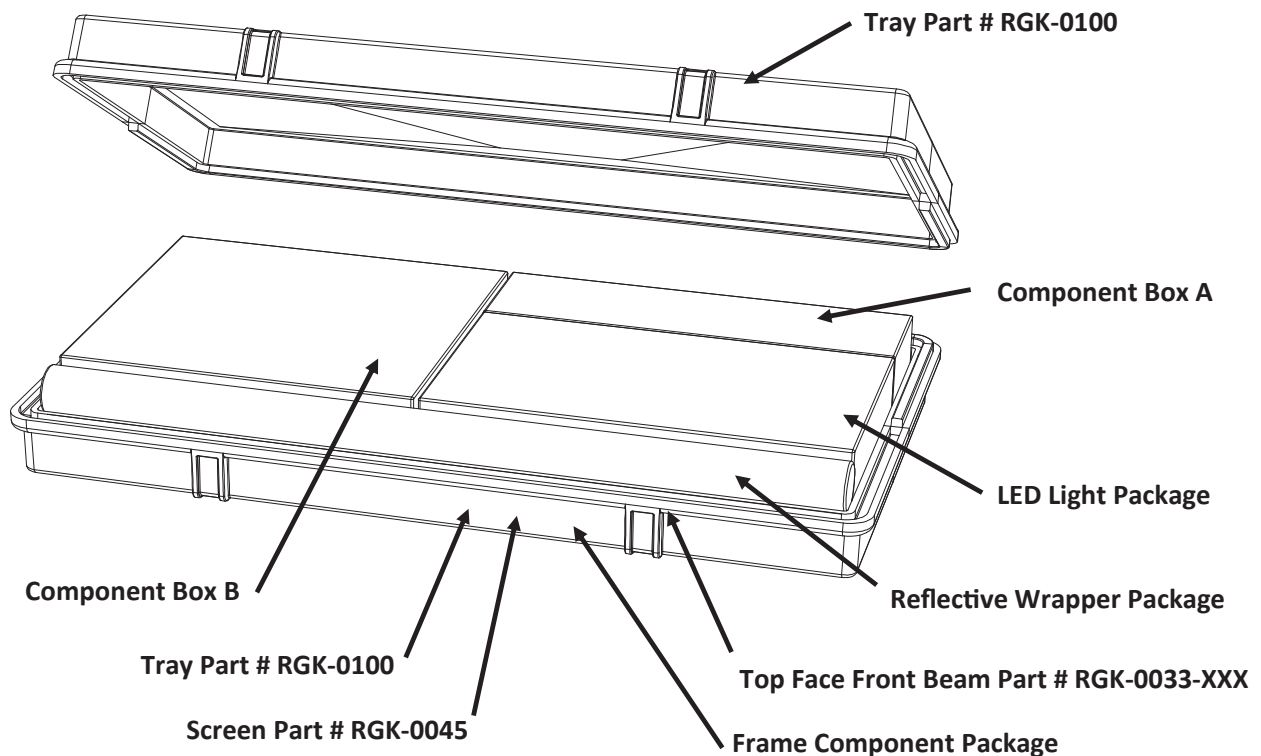

	Item	Description	Quantity	Part Number
FRAME COMPONENT PACKAGE	1	Posts	4	RGK-0011-XXX
	2	Bottom Face Beams	2	RGK-0017-XXX
	4	Top Face Back Beam	1	RGK-0050-XXX
REFLECTIVE WRAPPER PACKAGE	5	Reflective Wrapper	1	RGK-0031
	6	Reflective Cover	1	RGK-0049
LED LIGHT PACKAGE	7	Light Kit	1	RGK-0024
COMPONENT BOX A	8	Side Beams	4	RGK-0012-XXX
	9	Light Supports	2	RGK-0030-XXX
	10	Circulation Fan Bracket	1	RGK-0057-XXX
	11	Power Strip	1	RGK-0070
		Hygrometer & Thermometer	1	RGK-0063
		PH Control Kit	1	RGK-0064
		Trimming Scissors	1	RGK-0066
		Magnifier	1	RGK-0067
		Nutrient Kit 3-pack	1	RGK-0074
		Humidity Control 20-pack	1	RGK-0084
COMPONENT BOX B	12	Screen Brackets	4	RGK-0044
	13	Filter Housing Covers	2	RGK-0053
	14	Filter Housing Caps	4	RGK-0054
	15	Carbon Filters	2	RGK-0055
	16	Ventilation Fans	2	RGK-0056
	17	Bungees	2	RGK-0058
	18	Tape	1	RGK-0059
	19	Timer	1	RGK-0062
	20	Binder Clip 64-pack	1	RGK-0068
	21	Circulation Fan	1	RGK-0069
	22	Loop Tape Roll Black	1	RGK-0086
	23	Loop Tape Roll White	1	RGK-0087
		3-Gallon Grow Bags	3	RGK-0060
		Soil Meter	1	RGK-0065
		pH Meter	1	RGK-0065
	Liquid Measuring Syringe	1	RGK-0115	
	Hardware Pack	1	RGK-0071	

**HARDWARE
PACK**
(Part Number RGK-0071)

Item	Description	Quantity	Part Number
A	1/4-20 Screws	40	00950-15
B	4-40 Screws	2	00950-30
C	1/4-20 Nuts	40	94394-71
D	4-40 Nuts	2	152640-01
E	Nylon Push Rivets	16	RGK-0036
F	M5 Screws	8	RGK-0072
G	Cord Grommets	3	RGK-0073

A

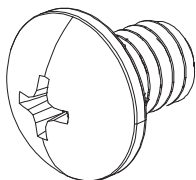

B

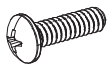

C

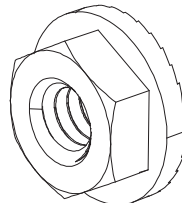

D



E

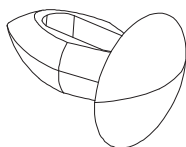

F

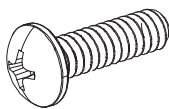

G

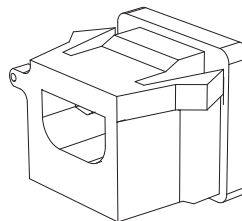

FRAME COMPONENTS

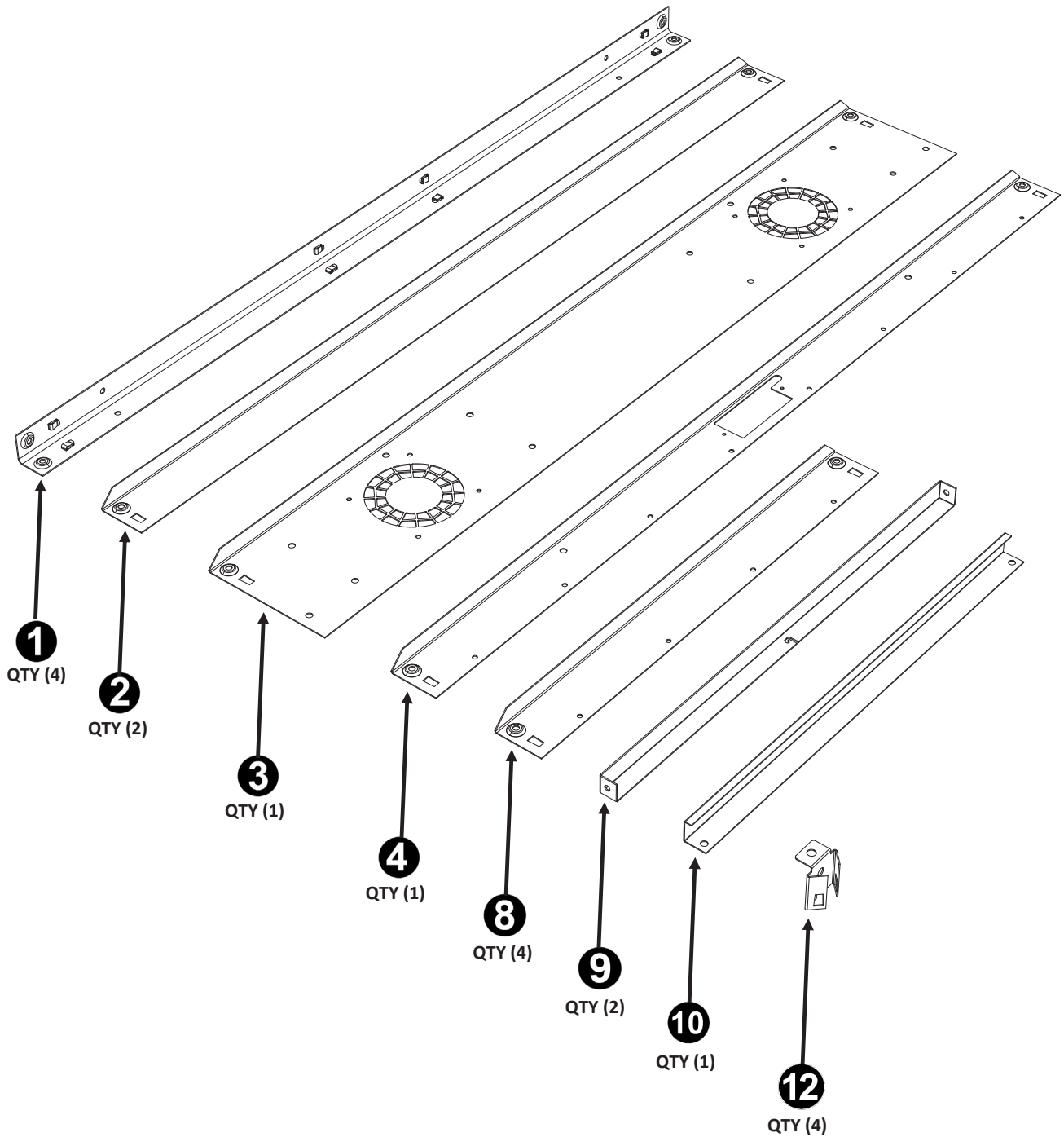
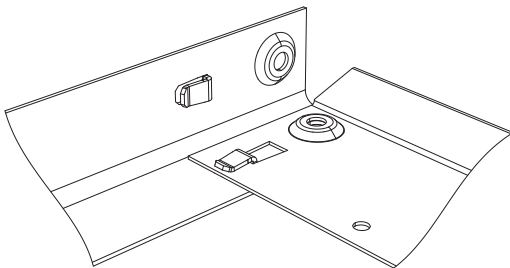
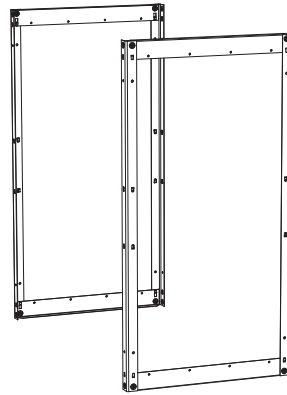
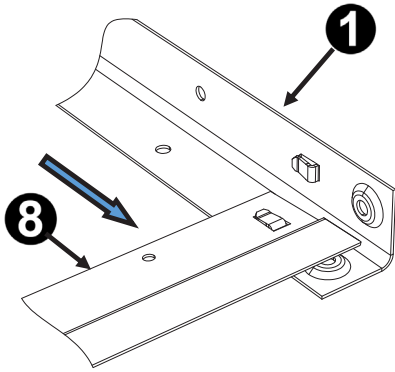

TABLE OF CONTENTS

Frame Assembly	7-12
Ventilation Fan Assembly	13-16
Reflective Wrapper Assembly	17-19
Base Assembly	20
Light Kit Assembly	21
Power Strip Assembly	22
Reflective Cover Assembly	23-24
Electrical Assembly	25-26
Top Assembly	27



SIDE FRAMES

1. Align slot & lance between Side Beam **8** and Post **1**
2. Tap Beam with rubber mallet to engage lance & to align holes
3. Insert Screw **A** into hole & HAND-TIGHTEN with Nut **C**
4. Repeat steps 1-3 to create a Side Frame
5. Repeat steps 1-4 to create a second Side Frame

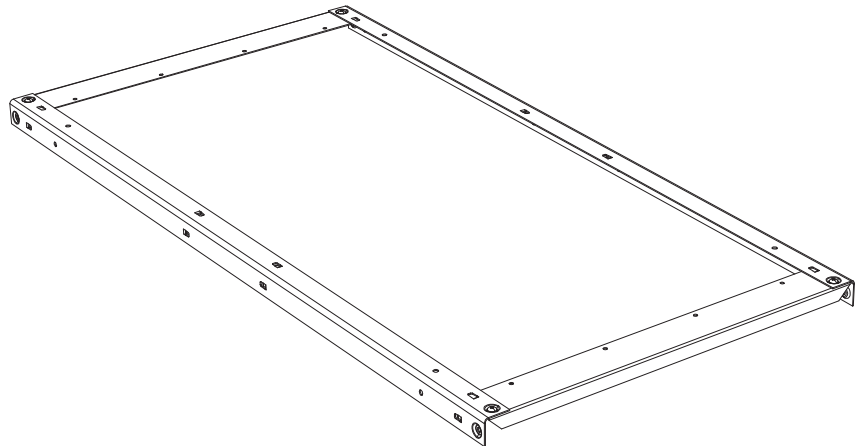
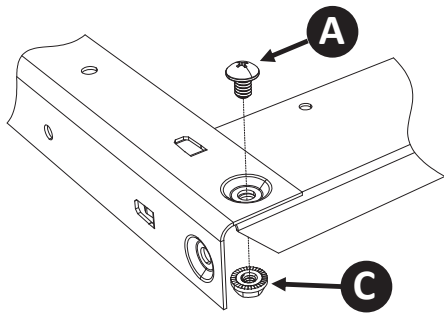

FACE BEAMS

1. Align slots & lances between Top Face Front Beam ③ to both Side Frames
2. Tap Beam with rubber mallet to engage lance & to align holes
3. Insert Screw ① into holes & HAND-TIGHTEN with Nut ②
4. Repeat Steps 1-3 to assemble Top Face Back Beam ④ 
5. Repeat Steps 1-3 to assemble both Bottom Face Beams ②
6. Move assembled frame onto level surface, square-up and tighten all fasteners

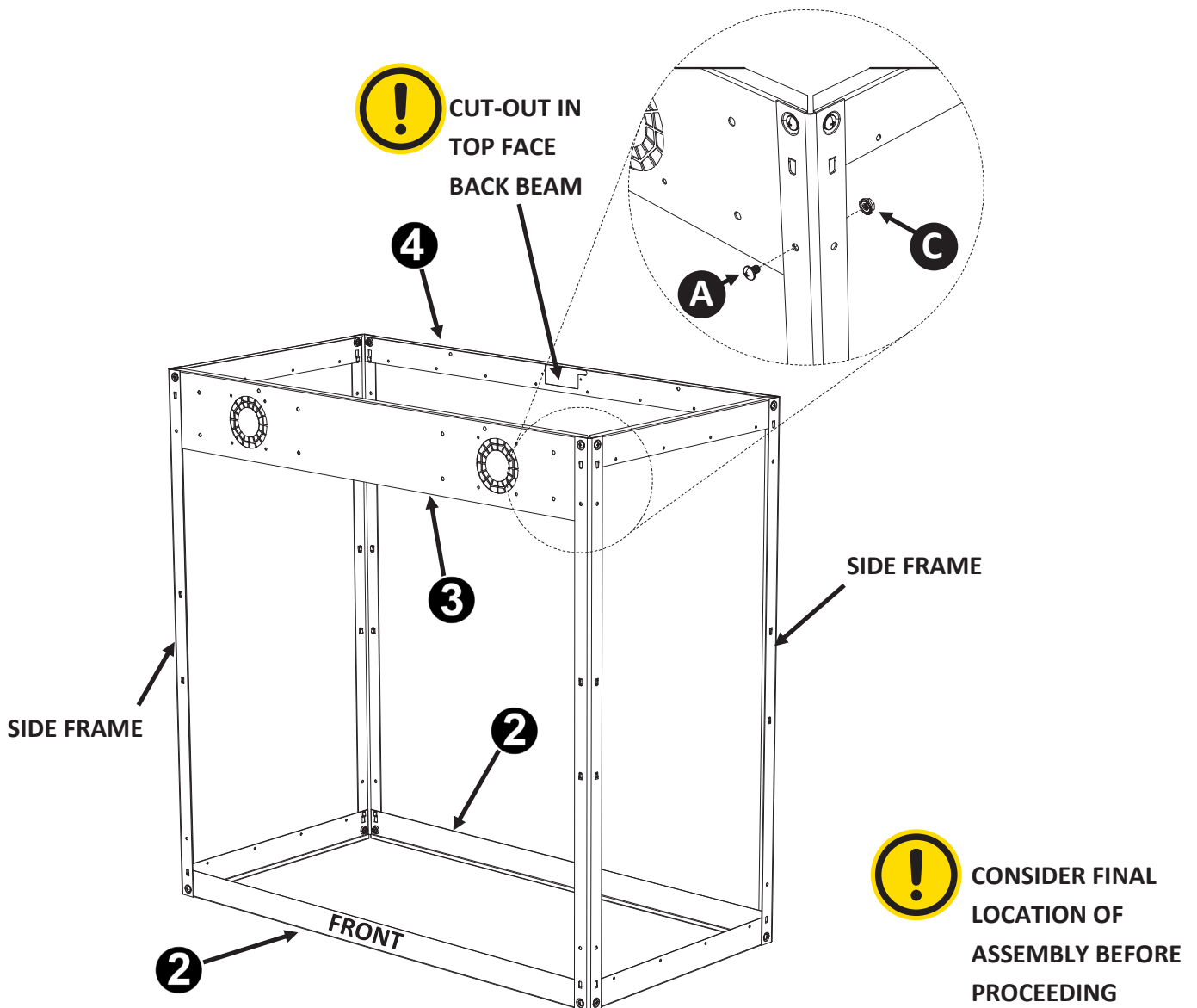

LIGHT SUPPORTS

1. Insert Light Supports **9** between Top Face Beams & align holes 
2. Insert Screw **A** into holes & tighten with Nut **C**



NOTE ORIENTATION ON VERTICAL FLANGE

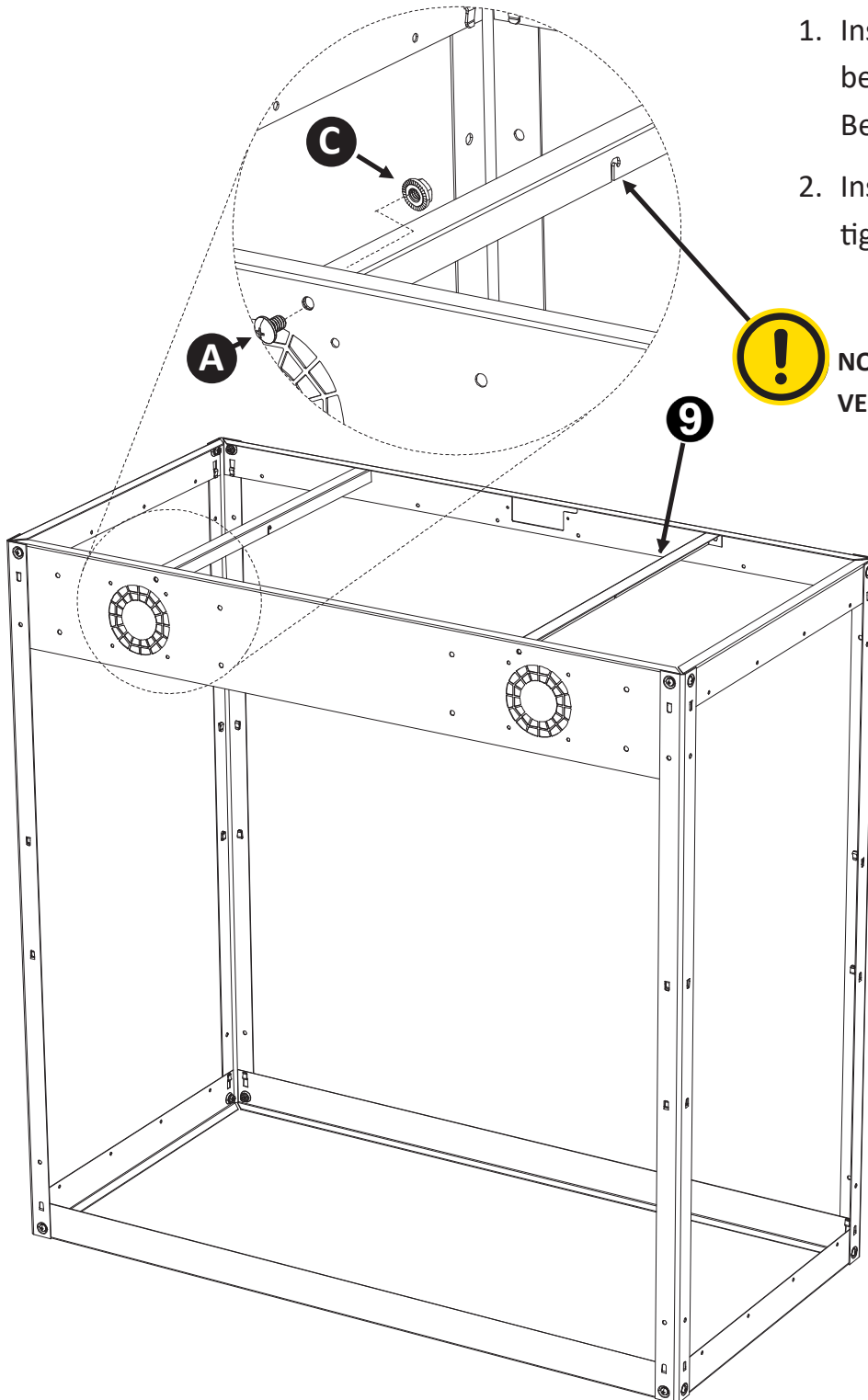

SCREEN BRACKETS

1. Slide Screen Brackets **12** over lower lances on Posts 
2. Tap Brackets to engage lances with rubber mallet

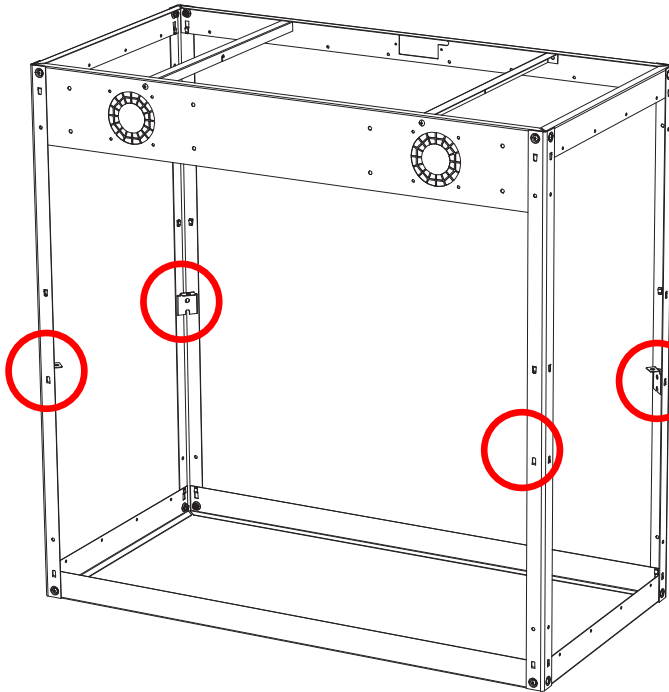

LOWER LANCES

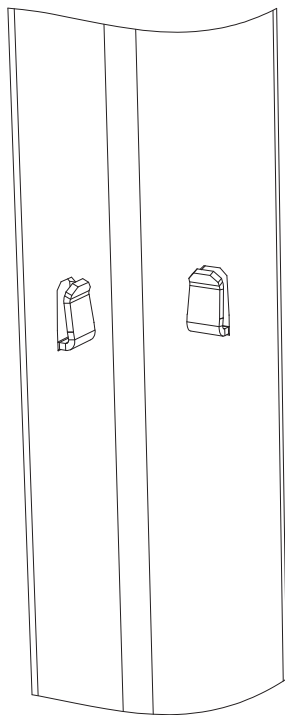

12

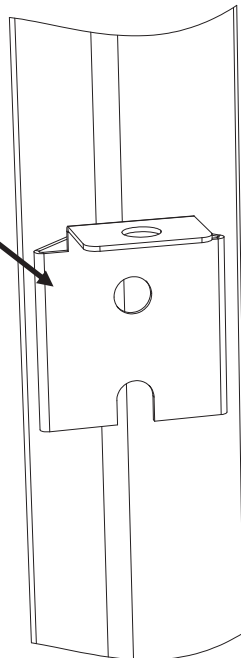

CIRCULATION FAN BRACKET

1. Align Circulation Fan Bracket **10** holes over Screen Bracket holes 
2. Insert Screw **A** into holes & tighten with Nut **C**

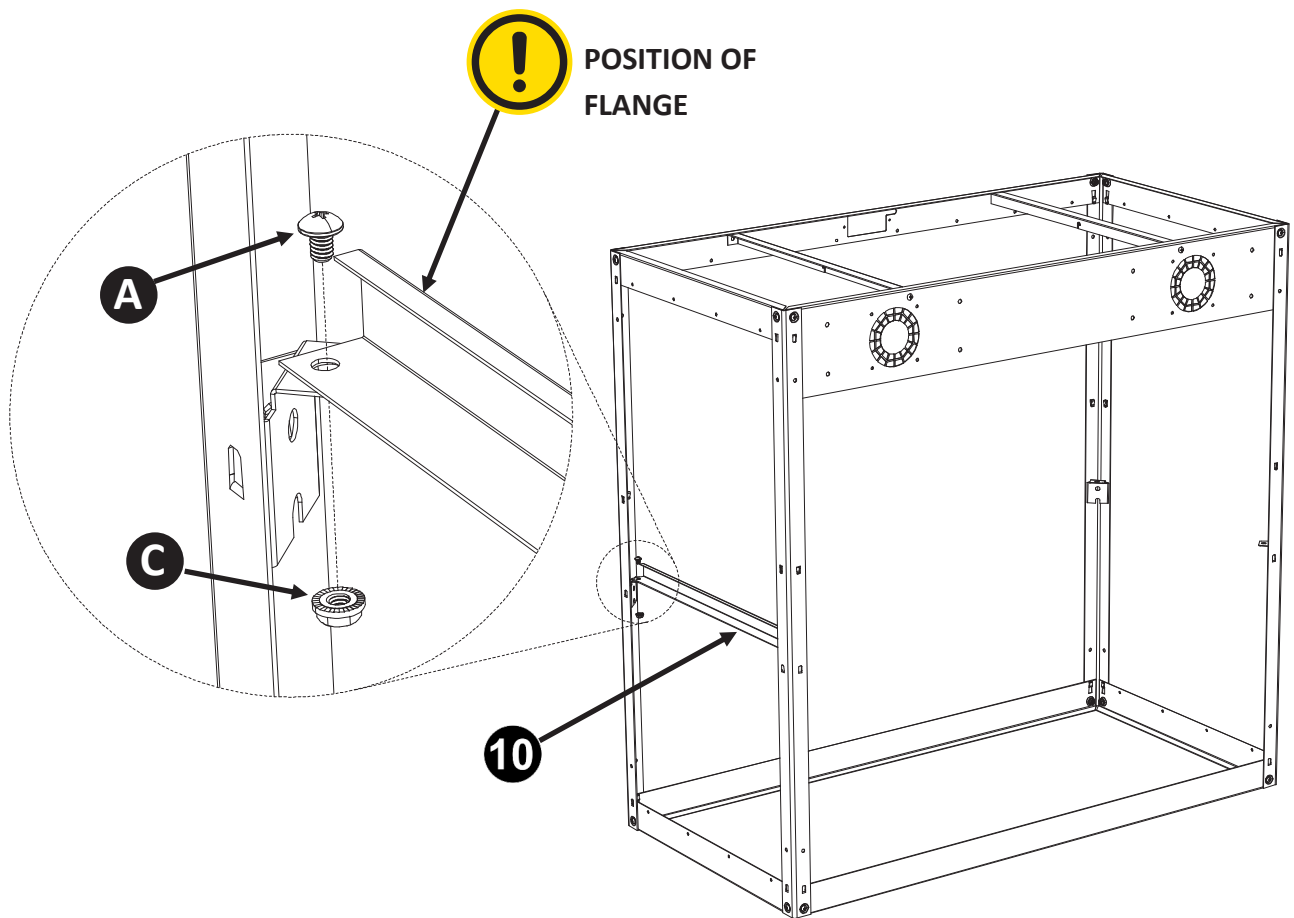

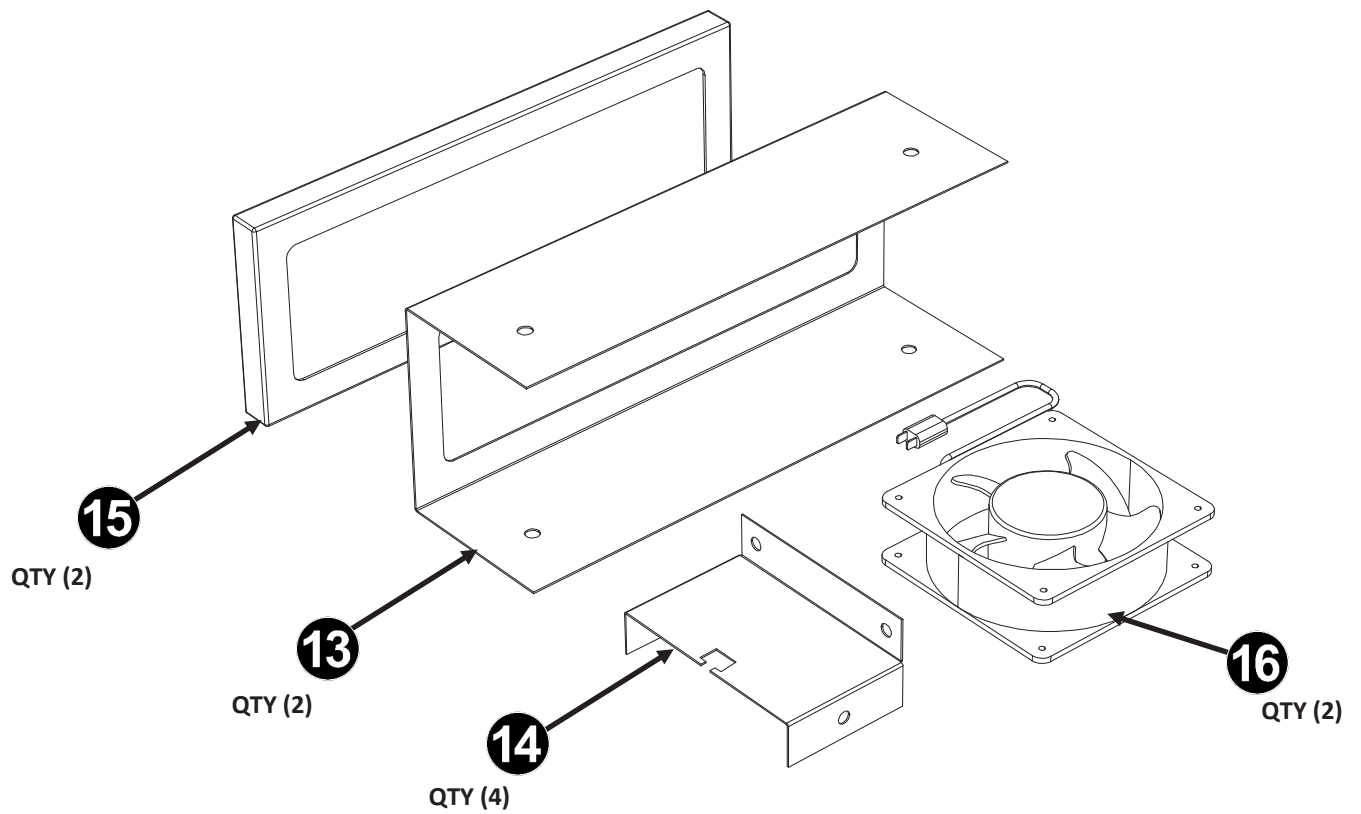

VENTILATION FAN ASSEMBLY



! BE CAUTIOUS OF SHARP EDGES DURING ASSEMBLY

VENTILATION FANS

1. Hand-Crimp Grommet **G** to cord on fan **16** (5" from fan). 
2. Make note of fan airflow direction and Align Fan holes to Top Face Front Beam **3** holes. 
3. Attach fans to top front beam using screws **F** (Do not tighten until all four screws are threaded)

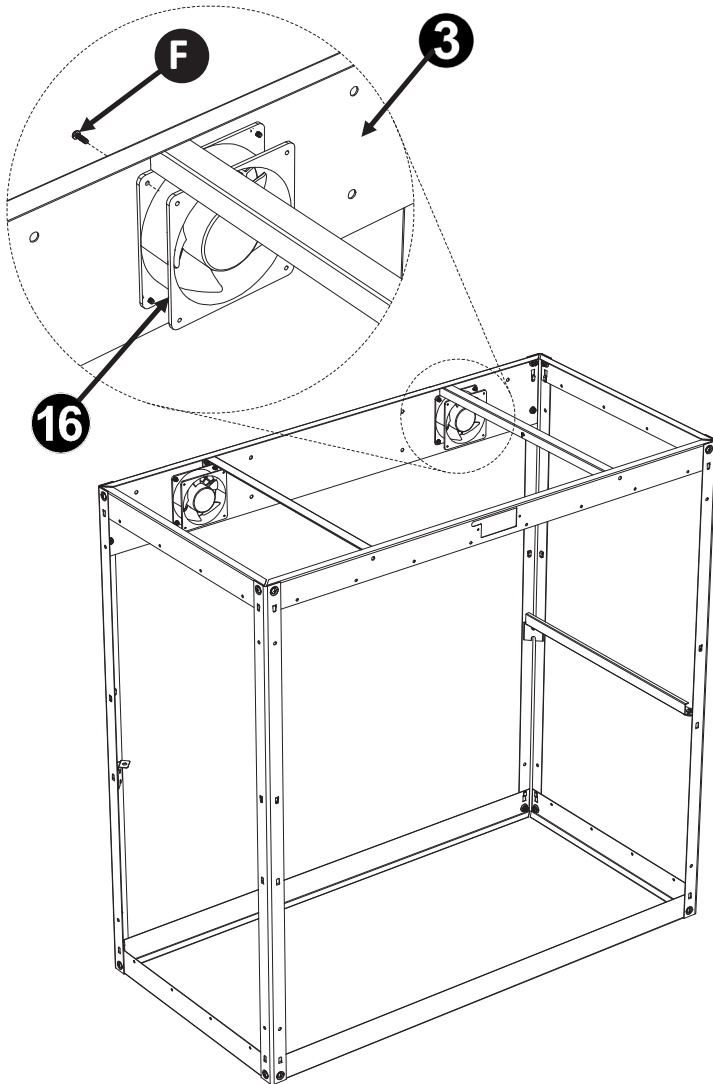

 **AIRFLOW ARROW STAMPED ON FAN**

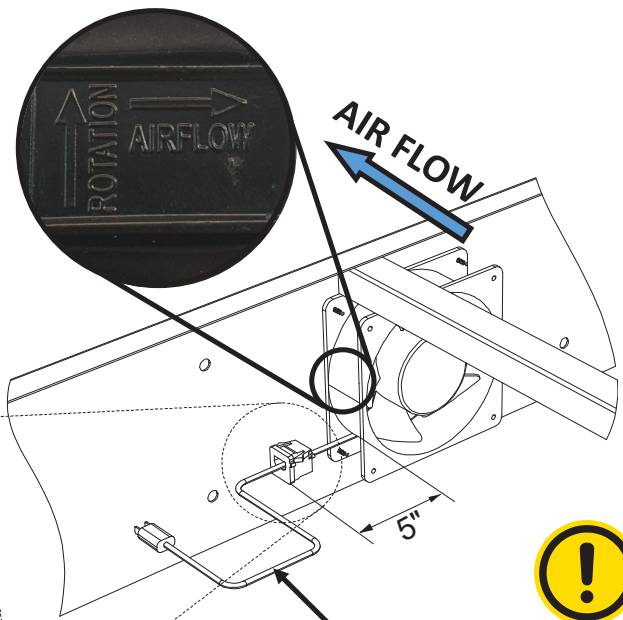

POSITION FAN SO CORD FACES CENTER OF UNIT

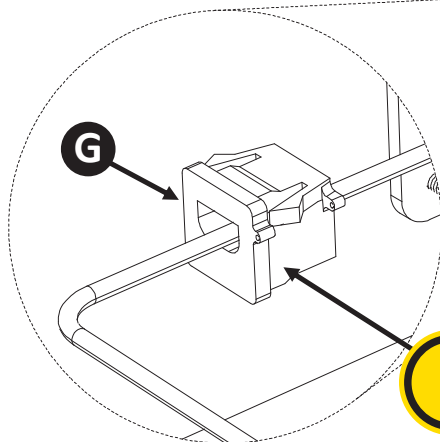

 **GROMMET FLANGE ON PLUG SIDE**

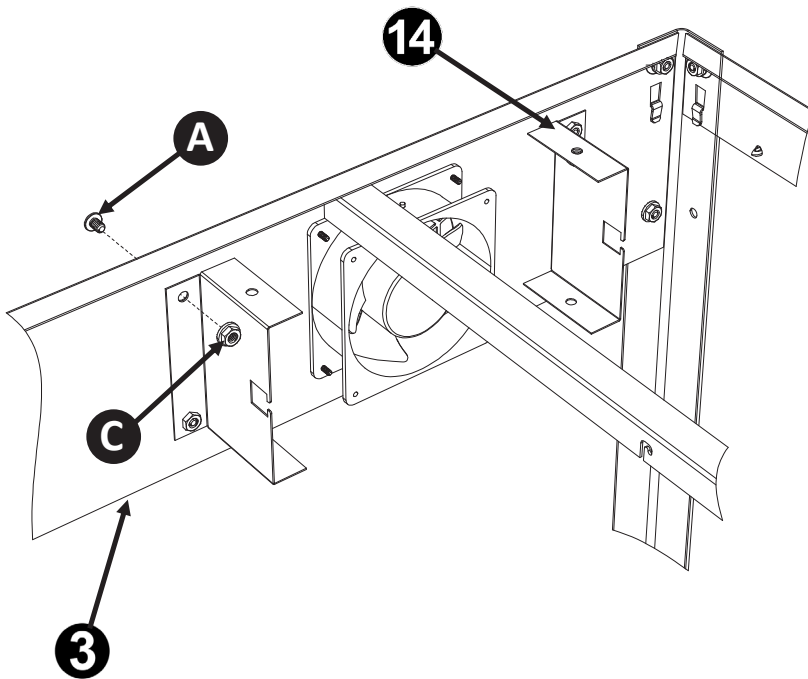

FILTER HOUSING CAPS

1. Align Filter Housing Cap **14** holes over Top Front Face Beam **3** holes
2. Insert Screw **A** into holes & tighten with Nut **C**
3. Slide Fan Cord into slot of Cap and push Grommet into square cutout
4. Hang plug end of Fan Cord over Light Support **9**



ENSURE GROMMET CLIPS INTO CUTOUT

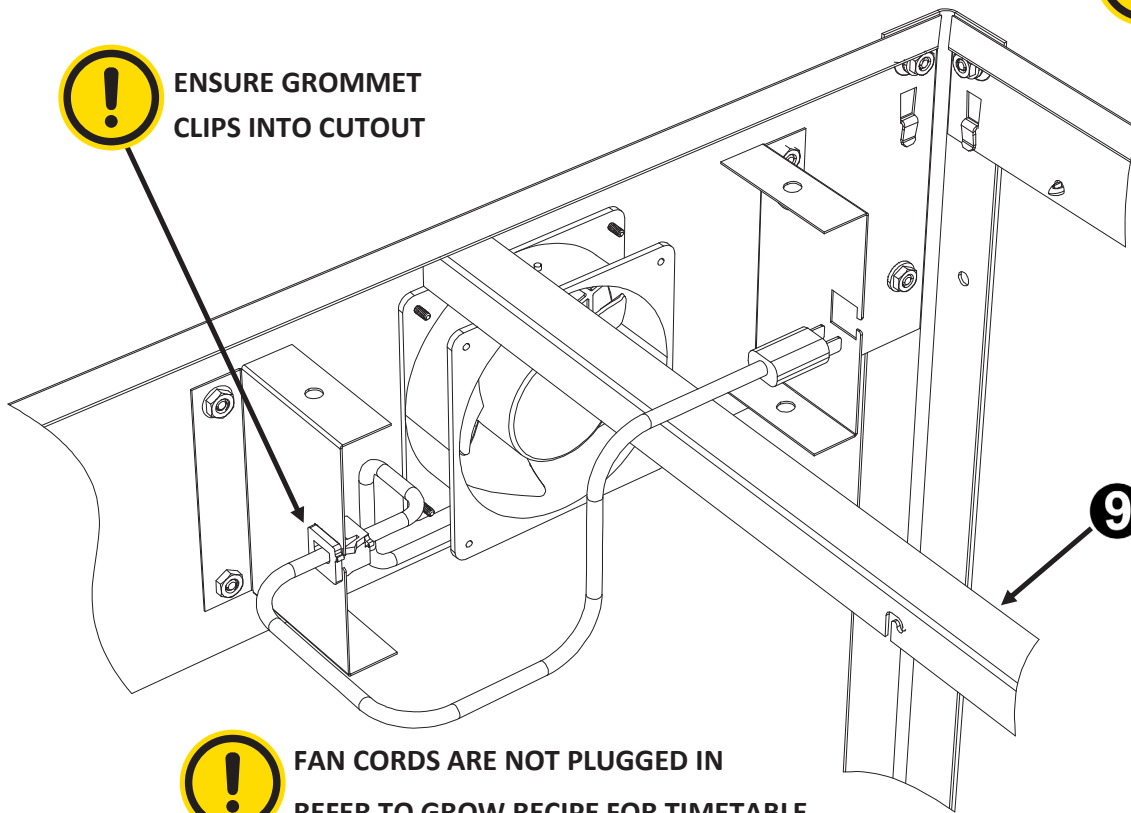

**FAN CORDS ARE NOT PLUGGED IN
REFER TO GROW RECIPE FOR TIMETABLE**

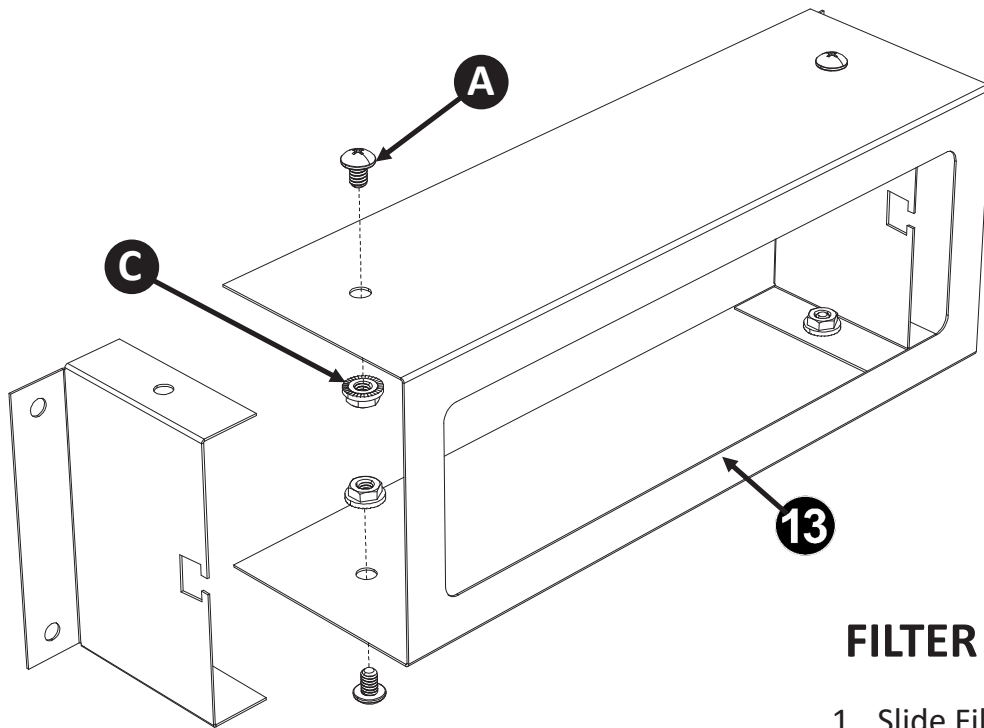

FILTER HOUSING COVER

1. Slide Filter Housing Cover **13** over Filter Housing Caps **14** and hold against Front Beam **3**
2. Insert Screw **A** into holes & tighten with Nut **C**

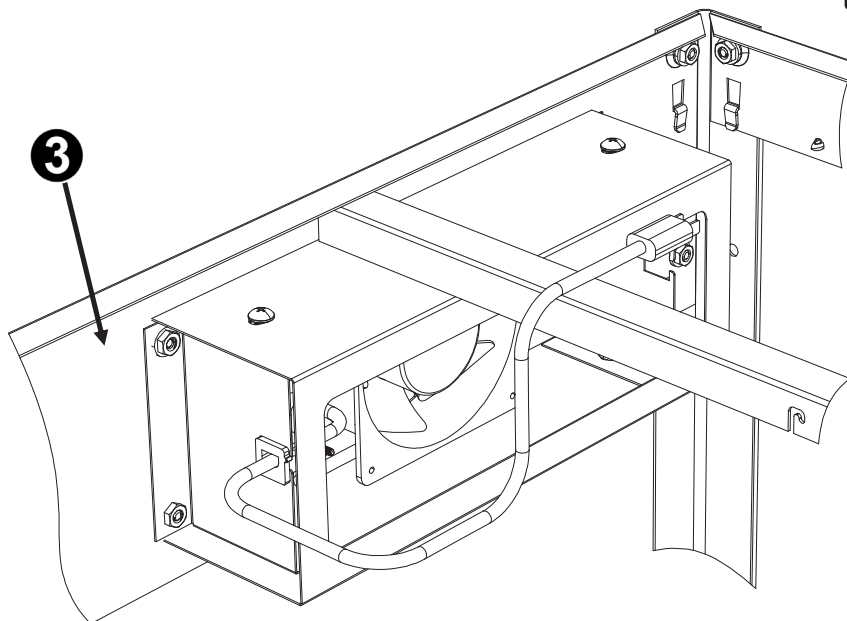

FILTERS

1. Slide Filter **15** into opening between Housing Cap & Cover 
2. Tighten all Filter Housing Fasteners
3. Cover openings with Tape **18** to improve filtering

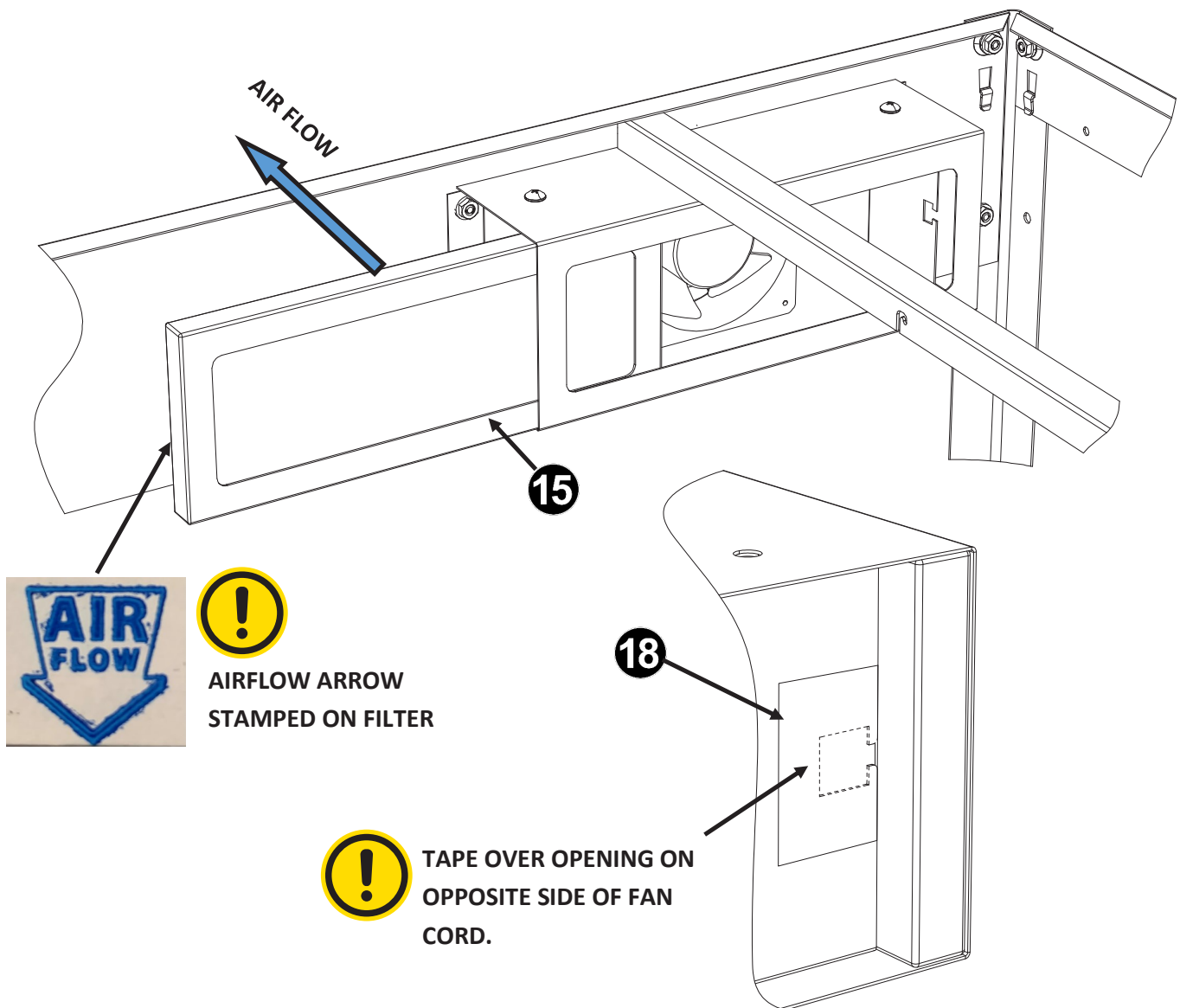

LOOP TAPE STRIPS

1. Cut two (2) pieces of black Loop Tape (Trade Name Velcro) **22** to a 44" length
2. Peel paper from back of Loop Tape and apply to side flange of both front posts **1**
3. Apply pressure to embed Loop Tape adhesive into post.

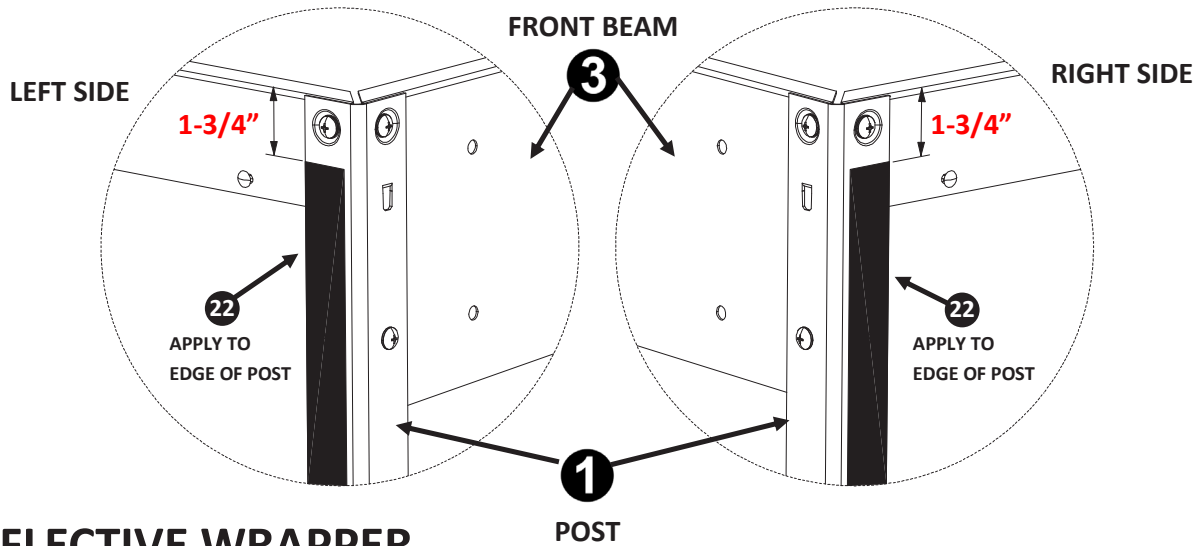

REFLECTIVE WRAPPER

1. Align Loop Tape edge of Wrapper **5** to one side of the frame and lightly embed Loop Tape 
2. Slowly unroll the Wrapper to align its holes with the frame holes and insert Nylon Push Rivets **E**
3. Pull wrapper taut and re-embed Loop Tape on both ends.

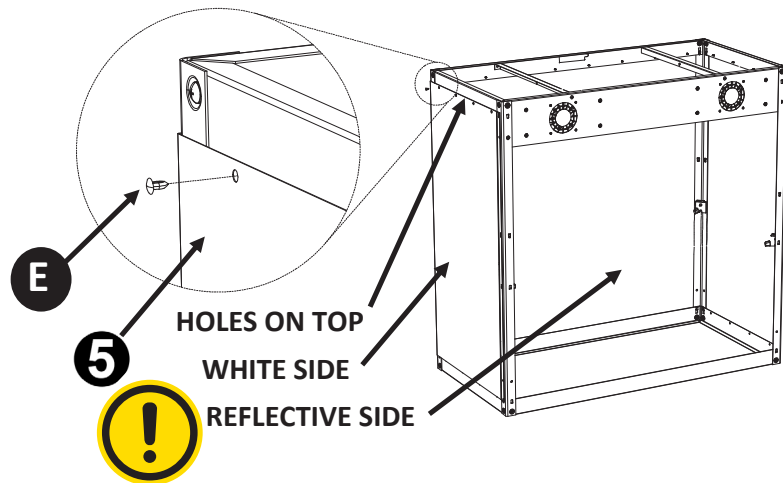

REFLECTIVE WRAPPER

1. Center Wrapper **5** at back of frame to align holes and insert (8) Nylon Push Rivets **E**
2. Pull wrapper taugt and re-embed Loop Tape on both ends.
3. Insert remaining Nylon Push Rivets into sides of frame.

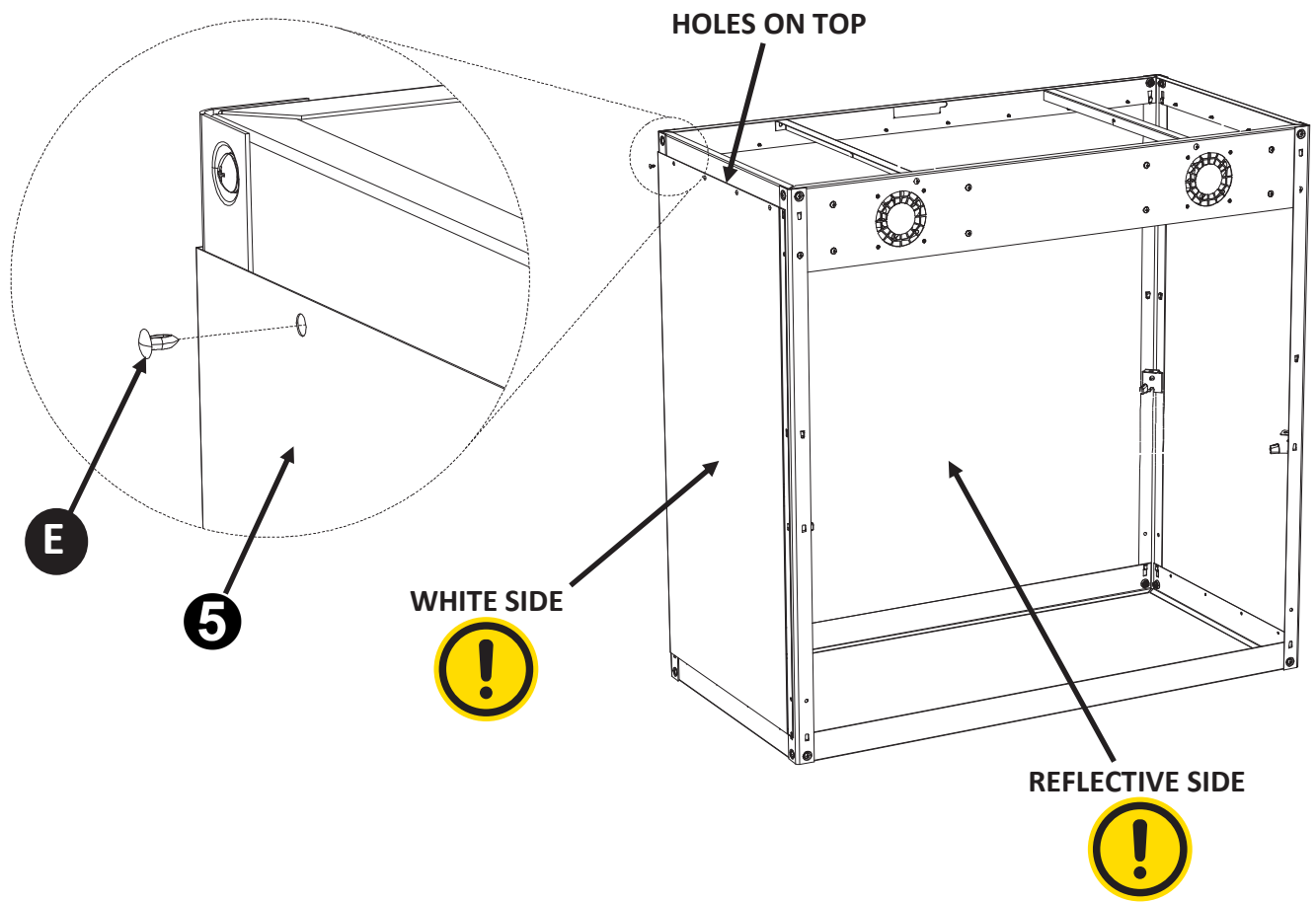

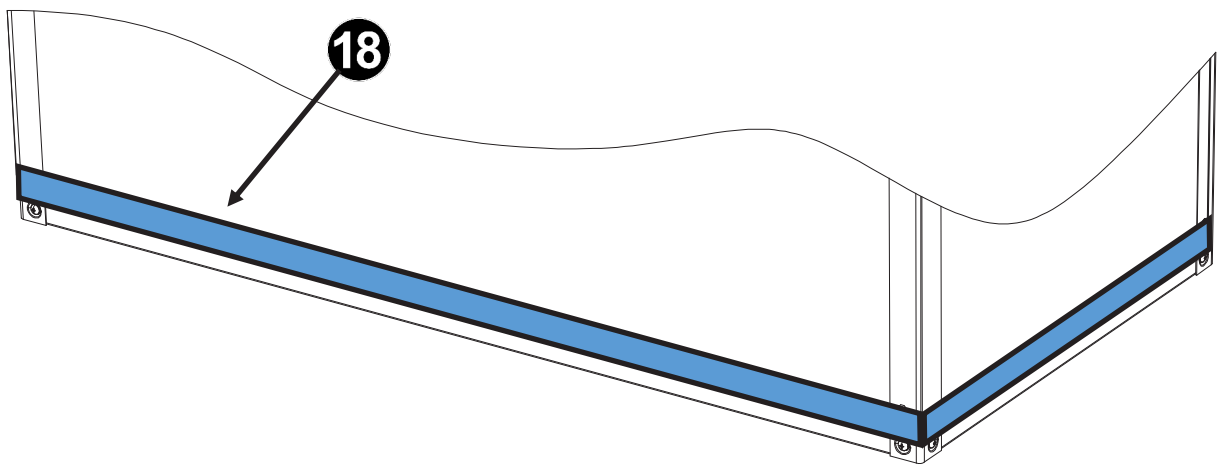
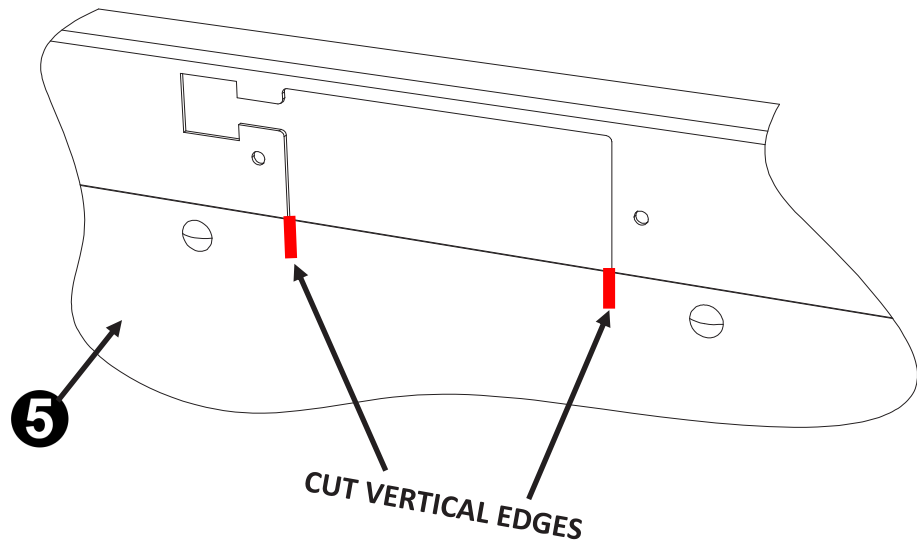

CUTTING & TAPING

1. Cut the vertical edge of wrapper **5** overlapping the power Strip opening
2. Apply tape **18** to base of wrapper edge at locations shown.



BASE

1. Position Tray on surface of final location 
2. Lift assembled unit vertically and insert inside Tray (May require a second person) 
3. Frame base must rest flat on inside edge of Tray

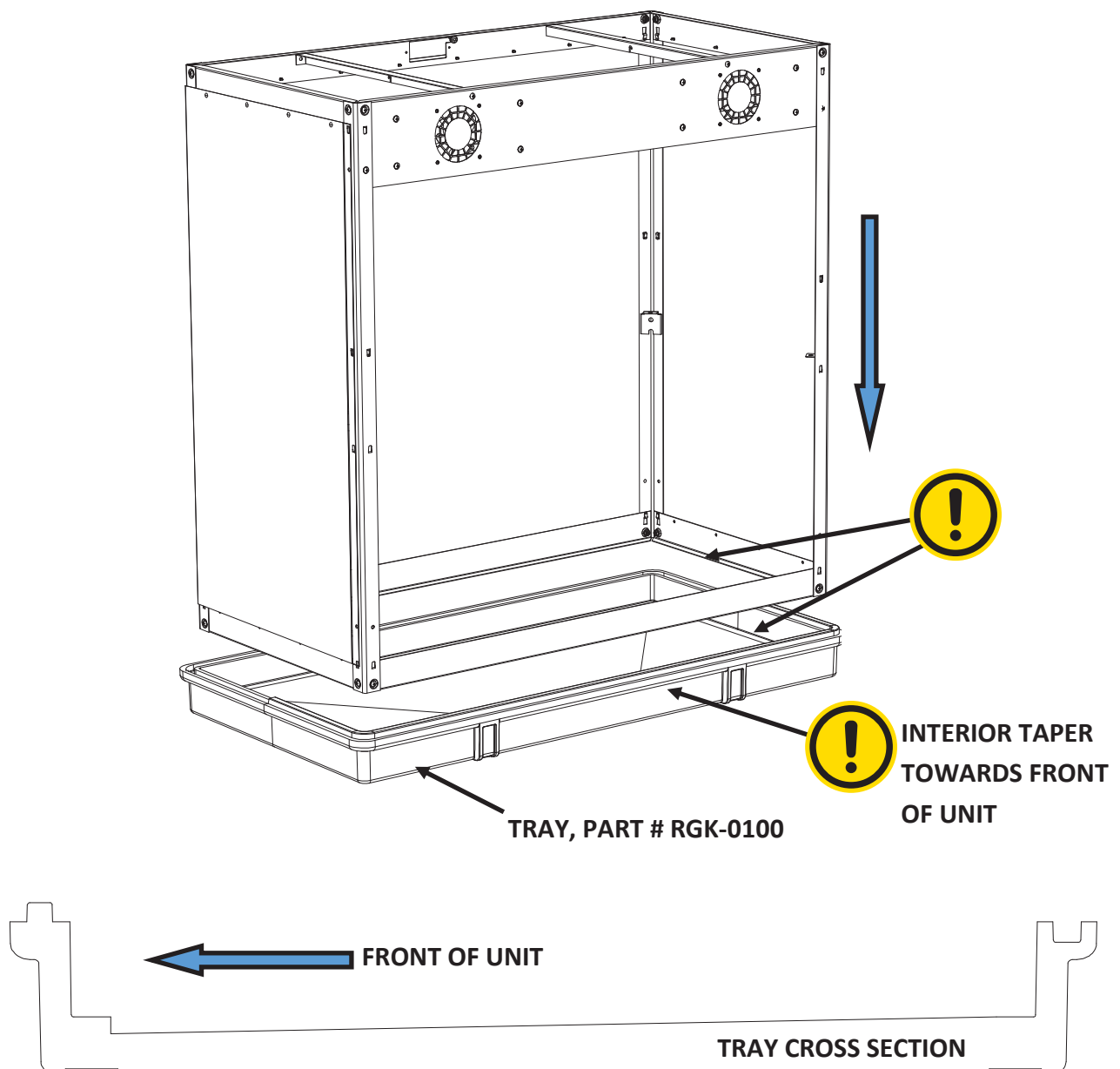

LIGHT KIT

The Light Kit 7 consists of two (2) rope ratchets, and a telephone cable that are not used for the GrowCase

1. Assemble wire harness clips into light panel slots.
2. Using pliers, crimp Cord Grommet G to light cord (18" from light) 
3. Hook wire harness loop from light support 9
4. Insert plug end of Light into opening in Top Face Back Beam 4
5. Slide Light cord into slot and push Grommet into square cutout

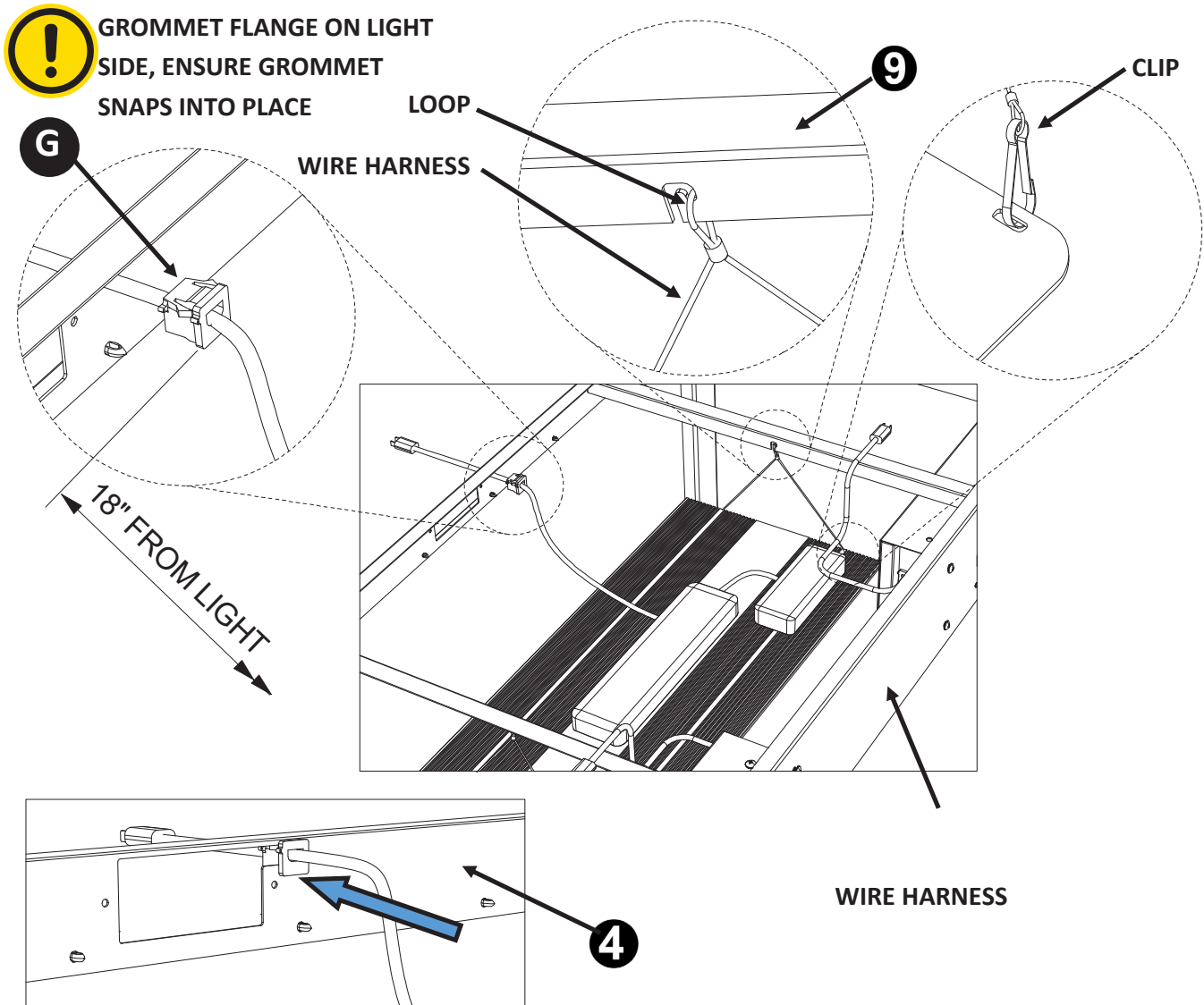

POWER STRIP

1. Insert the cord of Power Strip **11** through the opening in the Top Face Back Beam **4**
2. Insert Screw **B** through holes & tighten with Nut **D**

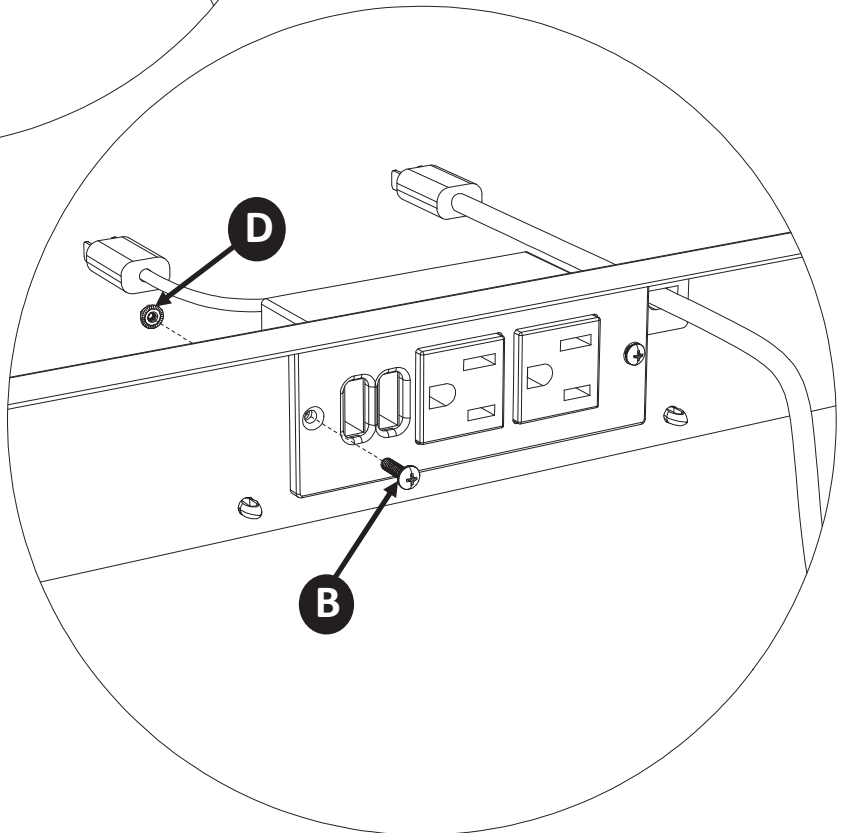
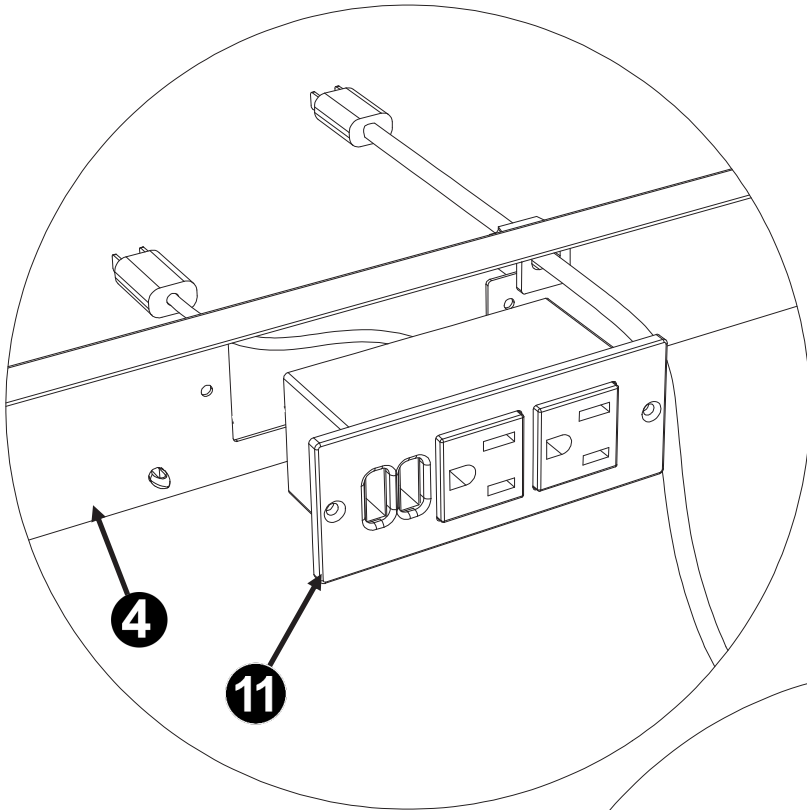



LOOP TAPE STRIPS

1. Cut one (1) piece of black Loop Tape **22** to a 45" length
2. Peel paper from back of Loop Tape and apply to lower edge of Top Face Front Beam **3**
3. Cut two (2) pieces of white Loop Tape **23** to a 39" length
4. Peel paper from back of Loop Tape and apply to front flange of front post **1**
5. Apply pressure to embed Loop Tape adhesive into Beam and Posts

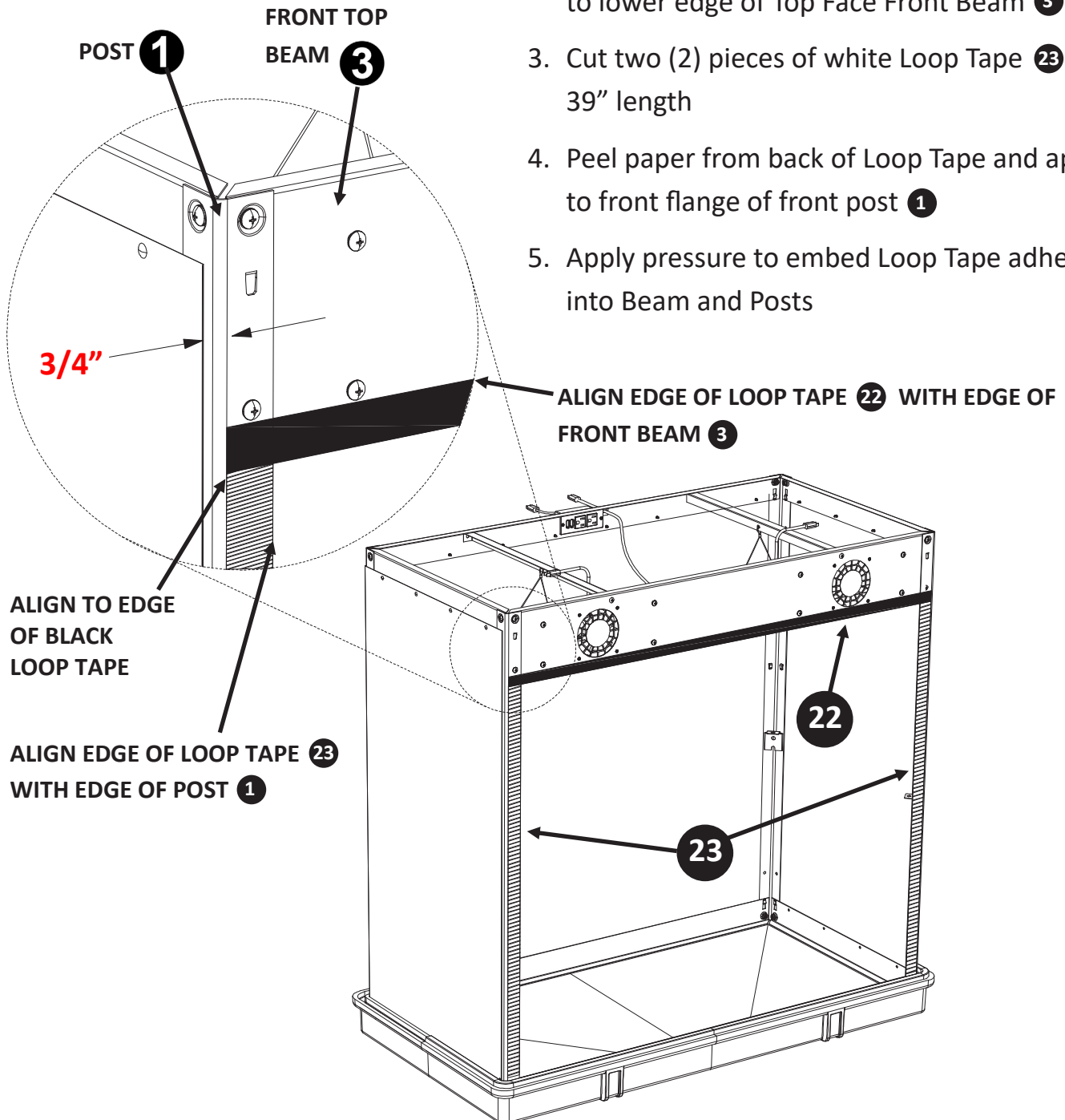

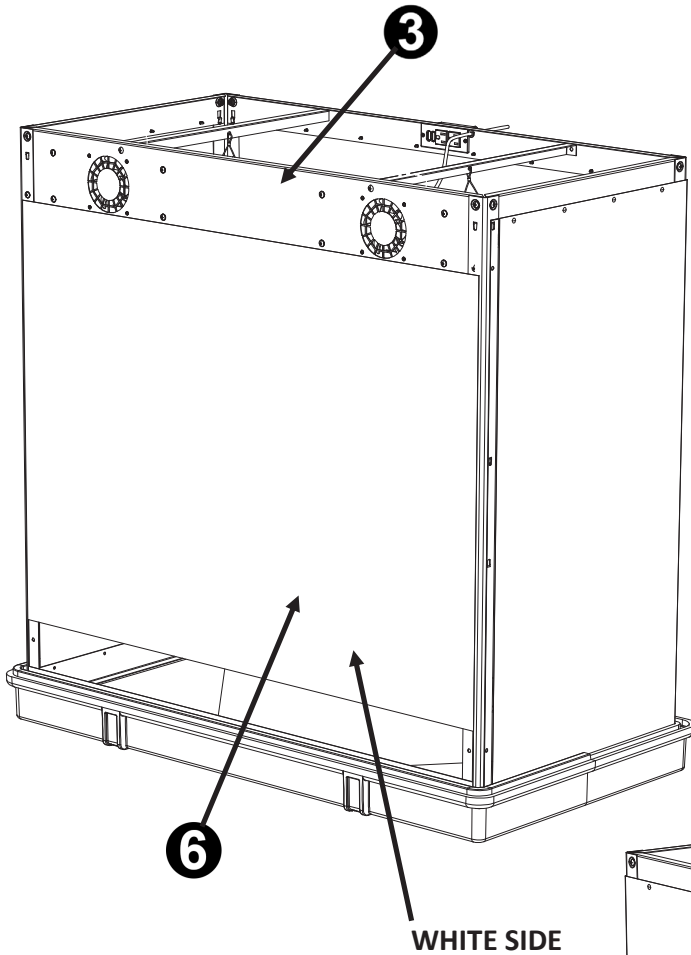

REFLECTIVE COVER

1. Unroll Reflective Cover **6**
2. Align & embed the top edge of black Loop Tape **22** to black Loop Tape on Top Face Front Beam **3**
3. Detach the white Loop Tape vertical edges, pull down tight, and re-embed Loop Tape

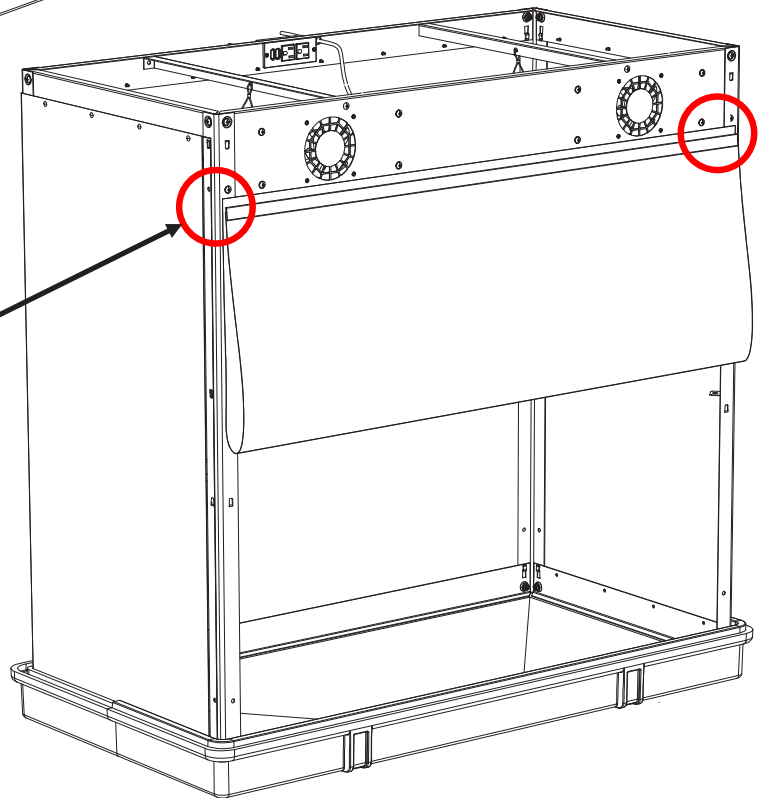

! NOTE: Surface magnets on bottom of Cover are used to hold it up during plant maintenance.

TIMER

1. Set the clock on Timer **19** (details included w/timer)
2. Set the program on Timer to 20 hours "on" beginning at 4:00 am for all days of the week (details included w/timer)
3. Insert plug from Light **7** into Timer

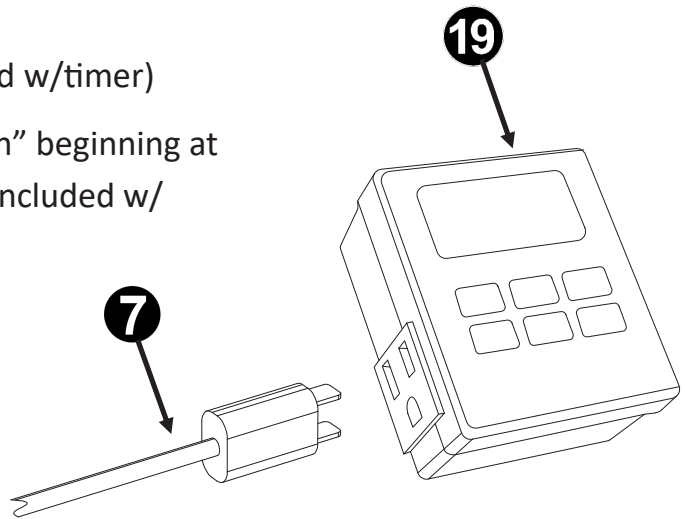

LIGHTING

1. Turn off dimming switch
2. Turn on light switch
3. Rotate dimming knob full-clockwise

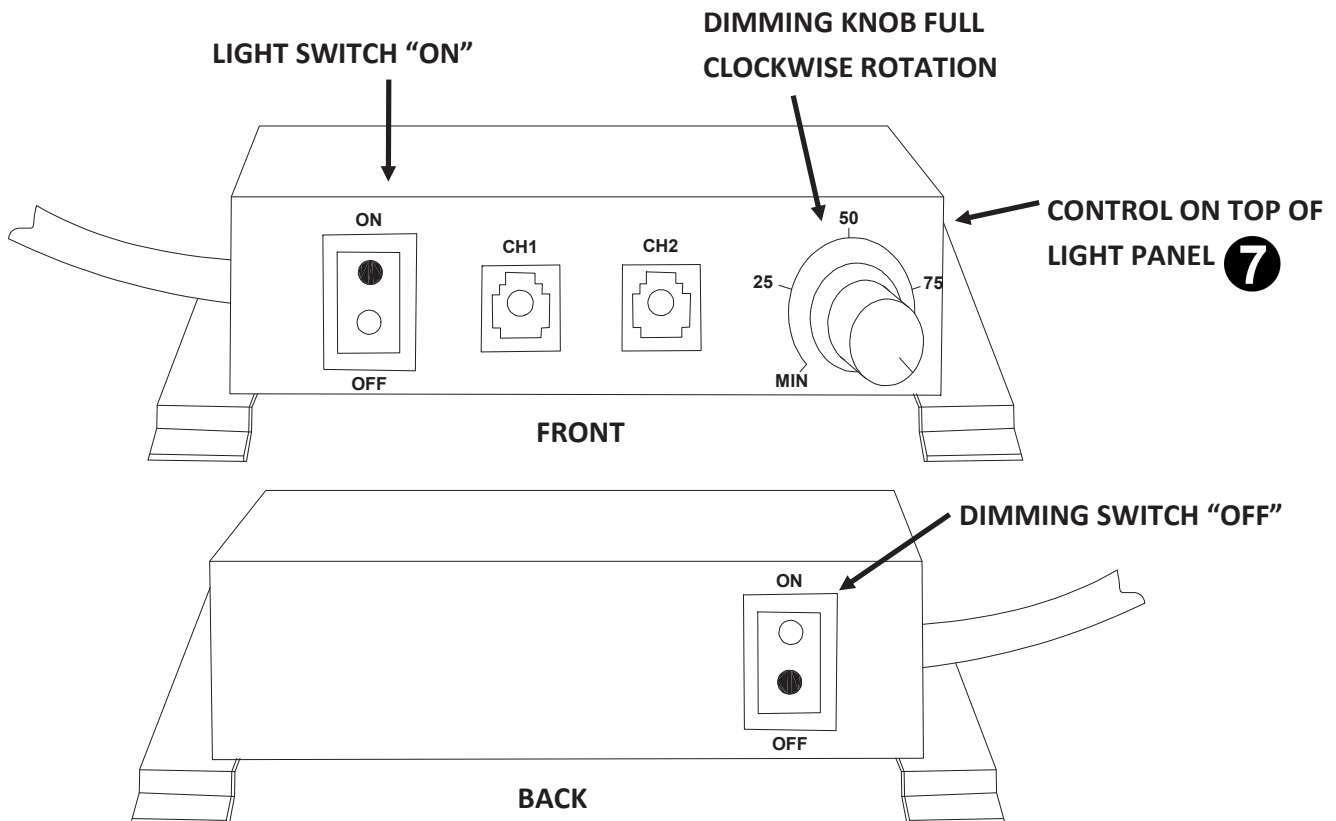

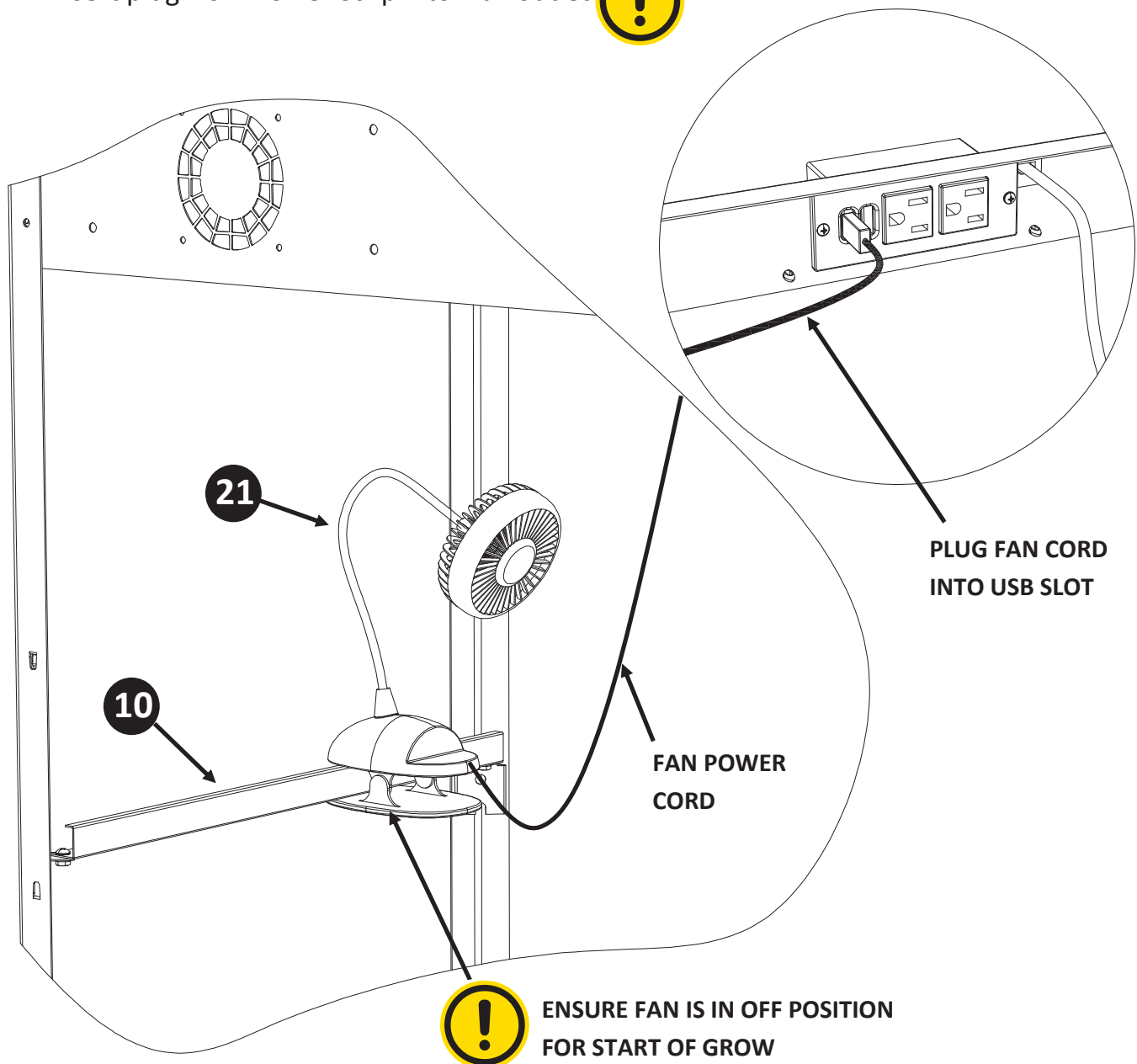

CIRCULATION FAN

1. Clip Circulation Fan **21** to Circulation Fan Bracket **10**
2. Insert small end of fan power cord into Circulation Fan
3. Insert USB end into USB port on Power Strip **11**
4. Insert plug from Power Strip into wall outlet 



TOP

1. Position Tray on top surface of Frame 
2. Apply the GrowCase sticker located in the “Documents Folder” to the Top Face Front Beam 

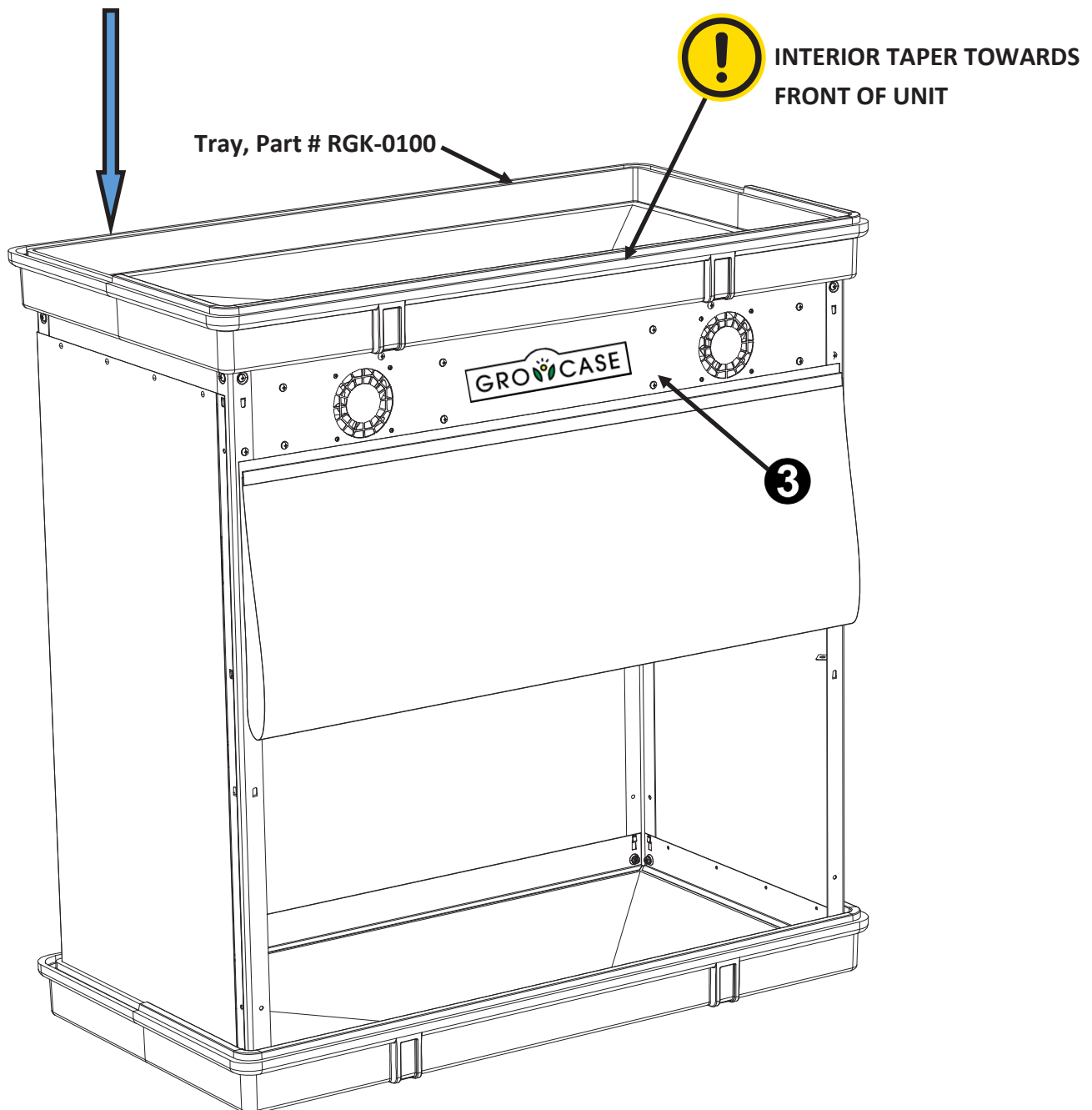



3002 N. BURDICK ST.
KALAMAZOO, MI 49004

INFO@SHOPGROWCASE.COM
SHOPGROWCASE.COM

